

# 405/5 Ward Avenue, Potts Point

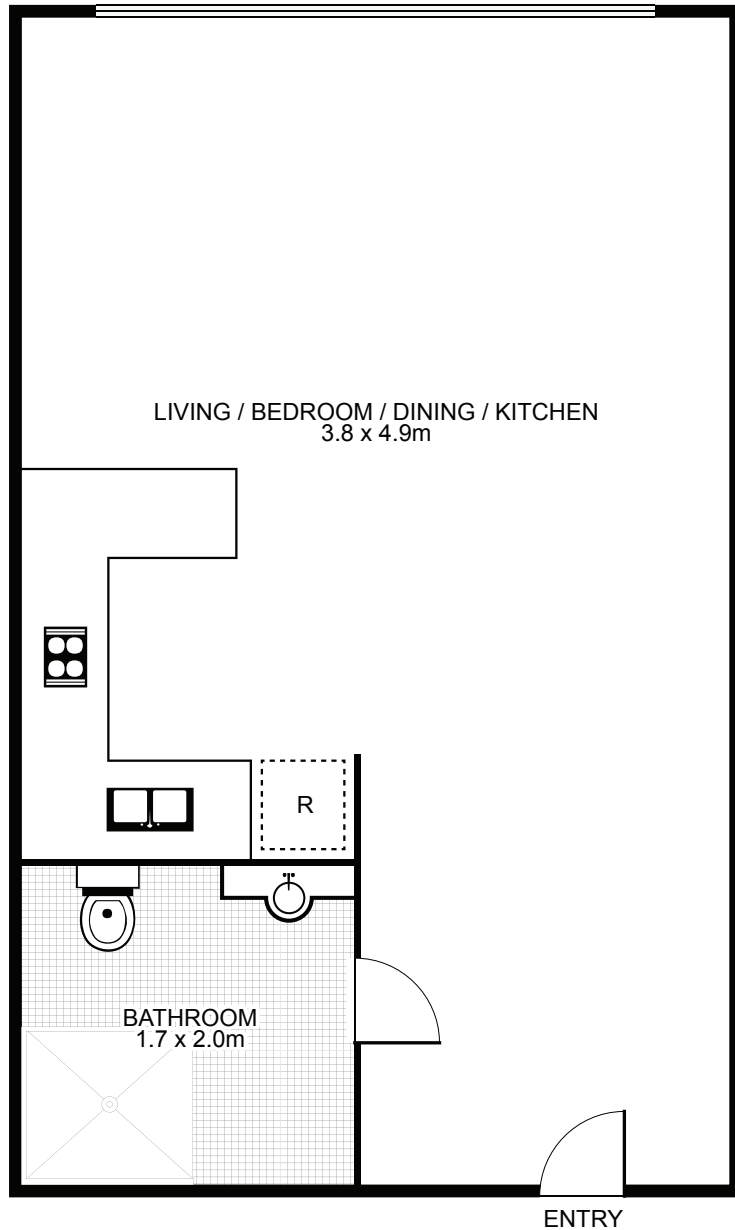

NORTH



## Property Specifications:

Total Size: 27m2  
- Internal 27m2 (Level 4)

## Levies are approximately per quarter:

Strata: \$844  
Council: \$277  
Water: \$185

## Strata Manager

Skyliving Strata  
Ph: 9299 1100

"Clairmont" was registered in 1994