

FOR SALE



6/1389-1397 Pacific Highway, Warrawee



MODERN ONE BEDROOM WITH ENTERTAINERS COURTYARD

Be surprised with this modern one bedroom ground floor apartment located in a secure building in a peaceful and leafy district. The apartment offers a sunny, relaxing and entertaining lifestyle, boasting a generous open plan living and dining area that flows on to an alfresco courtyard. Conveniently located, it is within moments of Warrawee and Turramurra stations, village shops, numerous dining options and a well-known school catchment area with Warrawee Public School across the road.

- Stylish Caesarstone island bench top and European gas kitchen with Smeg appliances and dishwasher
- Fluid open plan living area with 'green' views from every room
- Spacious bedroom with built in wardrobe and ensuite bathroom
- Nice sized outdoor courtyard



Michael Kurosawa
0411 641 662

Jimmy Shi
0422 090 807

Email:
mk@infinityproperty.com.au
jimmy@infinityproperty.com.au

Infinity
PROPERTY AGENTS

Call us:

9699 9179

www.infinityproperty.com.au

6/1389 Pacific Highway, Warrawee

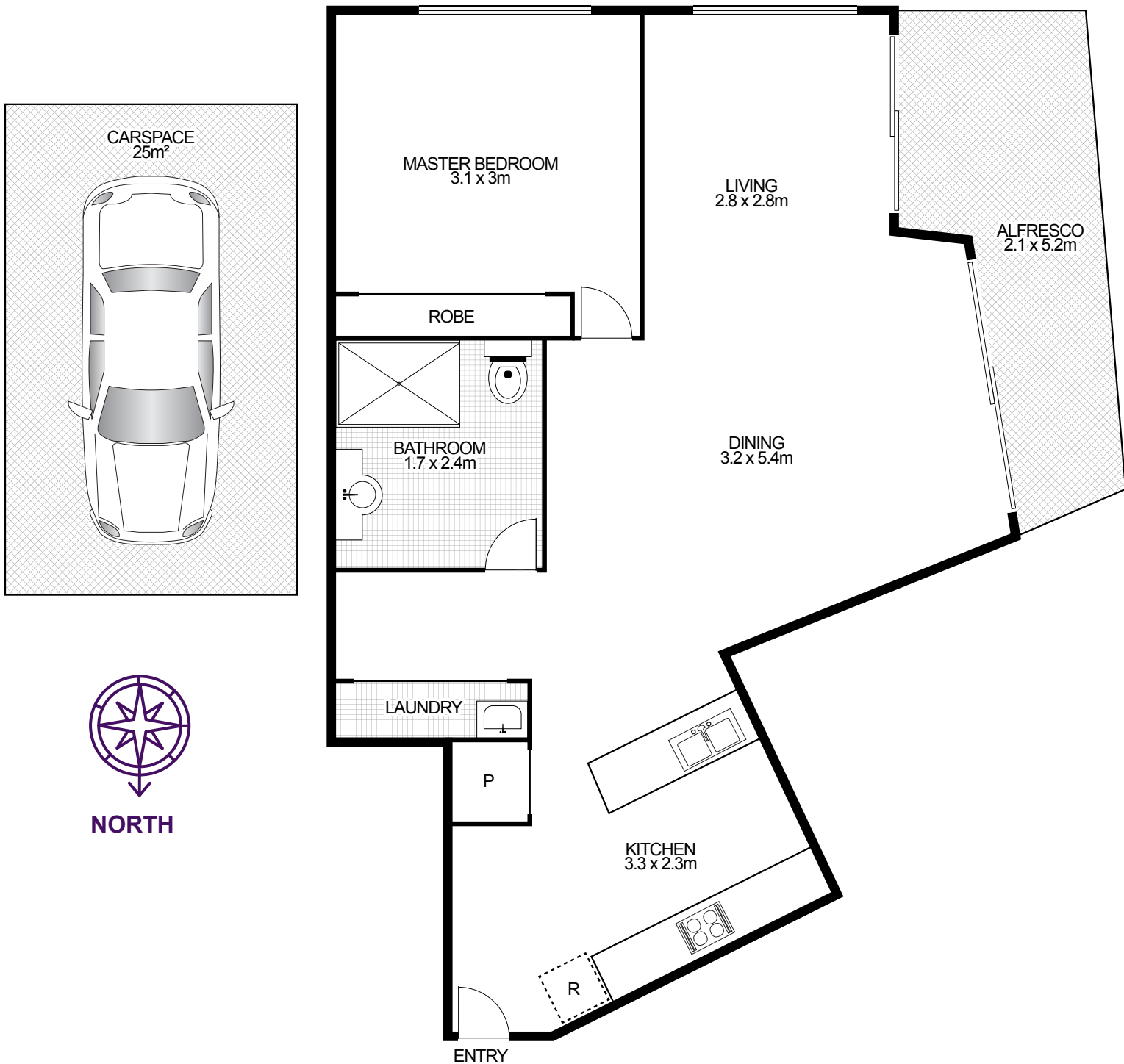

Property Specifications:

- Total Size: 129m²
- Internal living and balcony: 104m² (Ground)
- Car space 25m² (Upper basement level)

1389 Pacific Highway was registered in 2009

Levies are approximately per quarter:

Strata: \$803
Council: \$315
Water: \$172

Strata Manager

Strata Partners
Ph: 9417 2366